

# YES3(IP69K)系列不锈钢三相异步电动机

## YES3(IP69K) Series Stainless Steel Three Phase Induction Motors

### 一、Description

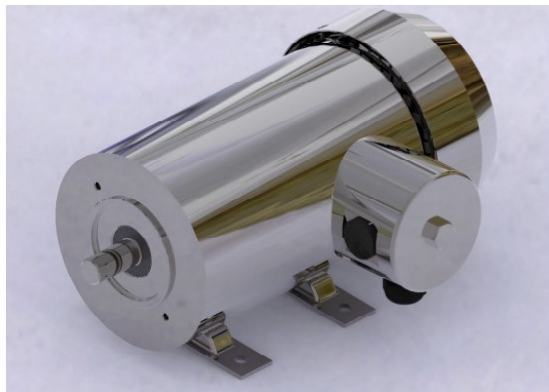

**Frame size: 80 ~ 180**

**Power: 0.55 ~ 22kW**

**Duty: S1**

**Cooling method: IC411**

**Energy Efficiency Class: IE3**

**Applications:** Can be widely applied in the machines where continuous duty and cleanliness are required, like food、beverage、medicine industry.

**Features:** Beautiful profile, high efficiency and energy saving (Level 3 of GB18613-2020), class F insulation, IP69K protection grade, clean, no-rust, strong anti-corrosion capability.

- \* All 304 Stainless Steel Frame, End bell At Both Ends, fan cover and shaft
- \* Space heater or Thermistor (PTC/PT100) available
- \* Antibacterial Treatment on All Internal Parts
- \* Round conduit box and housing, easy wash down
- \* 1.15 Service Factor
- \* Scratch resistant nameplate data laser printed(not etched) into frame to prevent corrosion and bacterial build up on nameplate
- \* All Double Lip Seals, Separate Housings For Dual Lip Seals
- \* Same Oversized 6200 Double Sealed Bearings At Both Ends
- \* SAE Threads & Bolts
- \* Sealing "O" Rings On Bolt & End Shields
- \* Double VPI Treatment & Epoxy Varnished

- \* End Shield & Body has Rebated Fitting
- \* TENV Temperature Rise Class "B" @1.0 or "F" @1.15\* Anti-bacterial Treatment on All Internal Parts, Anti-fungal, Anti-moisture Winding Treatment
- \* 4 Drain Plugs In Cast Stainless Steel End bells with T-drains Packed in Conduit Box
- \* Conduit Box & Cover Rubber Gasket
- \* Heavy Gauge Stamp Stainless Steel Feet 50-100 %
- \* Thicker Than Other Brand Names, Tig Welded
- \* Big Frames are cast feet
- \* Inverter Duty Wire
- \* Extra high breakdown torque.
- \* Patented vacuum epoxy encapsulation system ensures liquids won't penetrate the motor

### 性能数据 Performance Data

**380V 50Hz**

型号 Type	功率 kW	额定 电流 A	转速 r/min	效率 Eff.%	功率 因数 P.F	额定 转矩 N.m	堵转转矩 额定转矩 $\frac{T_{st}}{T_N}$	堵转电流 额定电流 $\frac{I_{st}}{I_N}$	最大转矩 额定转矩 $\frac{T_{max}}{T_N}$	噪声 dB(A)
同步转速 3000 r/min										
YES3-80M1-2	0.75	1.7	2840	80.7	0.82	2.5	2.3	7.0	2.3	62
YES3-80M2-2	1.1	2.4	2825	82.7	0.83	3.7	2.2	7.3	2.3	62
YES3-90S-2	1.5	3.2	2855	84.2	0.84	5.0	2.2	7.6	2.3	67
YES3-90L-2	2.2	4.6	2855	85.9	0.85	7.4	2.2	7.6	2.3	67
YES3-100L-2	3	6.0	2895	87.1	0.87	9.9	2.2	7.8	2.3	74
YES3-112M-2	4	7.8	2895	88.1	0.88	13.2	2.2	8.3	2.3	77
YES3-132S1-2	5.5	10.6	2920	89.2	0.88	18.0	2.0	8.3	2.3	79
YES3-132S2-2	7.5	14.4	2920	90.1	0.88	24.6	2.0	7.9	2.3	79
YES3-160M1-2	11	20.6	2960	91.2	0.89	35.5	2.0	8.1	2.3	81
YES3-160M2-2	15	27.9	2955	91.9	0.89	48.5	2.0	8.1	2.3	81
YES3-160L-2	18.5	34.2	2955	92.4	0.89	59.8	2.0	8.2	2.3	81
YES3-180M-2	22	40.5	2960	92.7	0.89	71.0	2.0	8.2	2.3	83

## 性能数据 Performance Data

380V 50Hz

型号 Type	功率 kW	额定 电流 A	转速 r/min	效率 Eff.%	功率 因数 P.F	额定 转矩 N.m	堵转转矩 额定转矩 $\frac{T_{st}}{T_N}$	堵转电流 额定电流 $\frac{I_{st}}{I_N}$	最大转矩 额定转矩 $\frac{T_{max}}{T_N}$	噪声 dB(A)
同步转速 1500 r/min										
YES3-80M1-4	0.55	1.4	1425	80.6	0.75	3.7	2.3	6.5	2.3	56
YES3-80M2-4	0.75	1.8	1425	82.5	0.75	5.0	2.3	6.6	2.3	56
YES3-90S-4	1.1	2.6	1420	84.1	0.76	7.4	2.3	6.8	2.3	59
YES3-90L-4	1.5	3.5	1420	85.3	0.77	10.1	2.3	7.0	2.3	59
YES3-100L1-4	2.2	4.8	1445	86.7	0.81	14.5	2.3	7.6	2.3	64
YES3-100L2-4	3	6.3	1440	87.7	0.82	19.8	2.3	7.6	2.3	64
YES3-112M-4	4	8.4	1460	88.6	0.82	26.1	2.2	7.8	2.3	65
YES3-132S-4	5.5	11.2	1460	89.6	0.83	36.0	2.0	7.9	2.3	71
YES3-132M-4	7.5	15.0	1460	90.4	0.84	49.0	2.0	7.5	2.3	71
YES3-160M-4	11	21.5	1470	91.4	0.85	71.7	2.2	7.7	2.3	73
YES3-160L-4	15	28.8	1470	92.1	0.86	97.8	2.2	7.8	2.3	73
YES3-180M-4	18.5	35.3	1475	92.6	0.86	120	2.0	7.8	2.3	76
YES3-180L-4	22	41.8	1475	93.0	0.86	142	2.0	7.8	2.3	76
同步转速 1000 r/min										
YES3-80M1-6	0.37	1.1	910	73.5	0.70	3.9	1.9	5.5	2.0	54
YES3-80M2-6	0.55	1.5	905	77.2	0.71	5.8	1.9	5.8	2.1	54
YES3-90S-6	0.75	2.0	940	78.9	0.71	7.7	2.0	6.0	2.1	57
YES3-90L-6	1.1	2.8	935	81.0	0.73	11.3	2.0	6.0	2.1	57
YES3-100L-6	1.5	3.8	955	82.5	0.73	15.0	2.0	6.5	2.1	61
YES3-112M-6	2.2	5.4	960	84.3	0.74	21.7	2.0	6.6	2.1	65
YES3-132S-6	3	7.2	975	85.6	0.74	29.4	1.9	6.8	2.1	69
YES3-132M1-6	4	9.5	975	86.8	0.74	39.2	1.9	6.8	2.1	69
YES3-132M2-6	5.5	12.7	970	88.0	0.75	54.1	2.0	7.0	2.1	69
YES3-160M-6	7.5	16.2	970	89.1	0.79	73.5	2.0	7.0	2.1	70
YES3-160L-6	11	23.1	970	90.3	0.80	108	2.0	7.2	2.1	70
YES3-180L-6	15	30.9	975	91.2	0.81	147	2.0	7.3	2.1	73

外形及安装尺寸 Dimensions

mm

B14 (机座无底脚、端盖上有小凸缘)

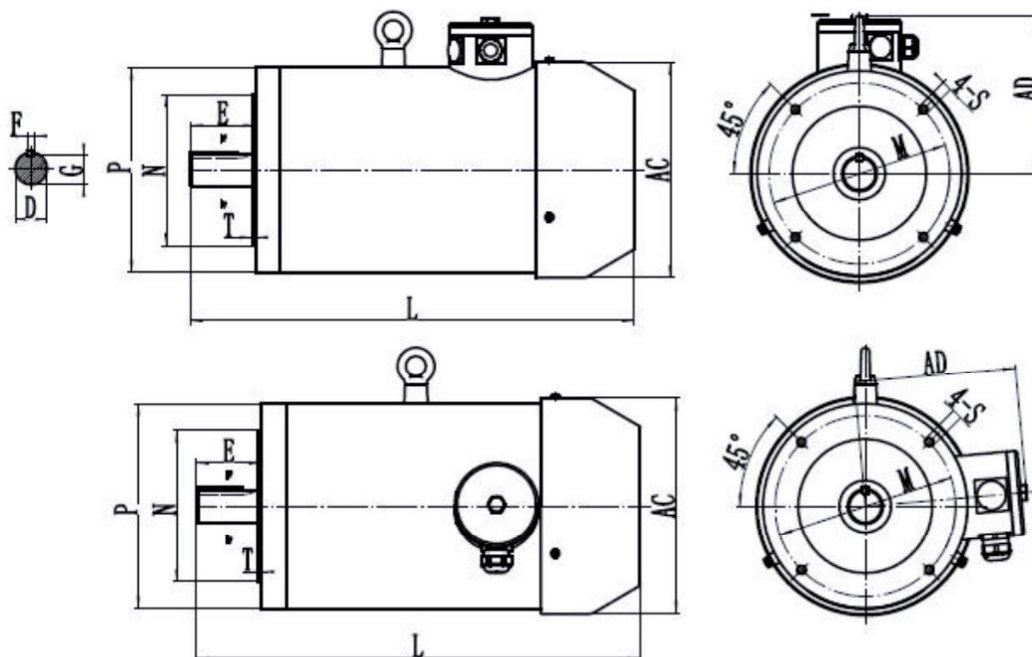

机座号 Frame	极数 Poles	安 装 尺 寸 及 公 差 Mounting Dimension									外 形 尺 寸 Overall Dimension			
		D	E	F	G	M	N	P	S	T	AC	AD	HF	L
80M1	2,4,6	19	40	6	15.5	100	80	144	4-M6	3	158	135	215	308
80M2	2,4													328
	6													338
90S	2,4,6	24	50	8	20	115	94	164	4-M8	3	178	150	240	354
90L	2,4,6													389
100L/L2	2,4	28	60	8	24	130	110	186	4-M8	3.5	200	150	250	449
100L1/L	4,6													409
112M	2,6	28	60	8	24	130	110	206	4-M8	3.5	220	180	292	427
	4													457
132S1/S	2,4,6	38	80	10	33	165	130	244	4-M10	3.5	260	200	332	496
132M1	6													541
132S2	2													
132M	4													
132M2	6													
160M1	2	42	110	12	37	265	230	298	4-M12	4	314	240	400	604
160M	4,6													644
160M2	2													
160L	2,4,6													
180M	2,4	48	110	14	42.5	300	250	337	4-M12	4	355	260	440	709
180L	4,6													734

外形及安装尺寸 Dimensions

mm

B34 (机座带底脚、端盖上有小凸缘)

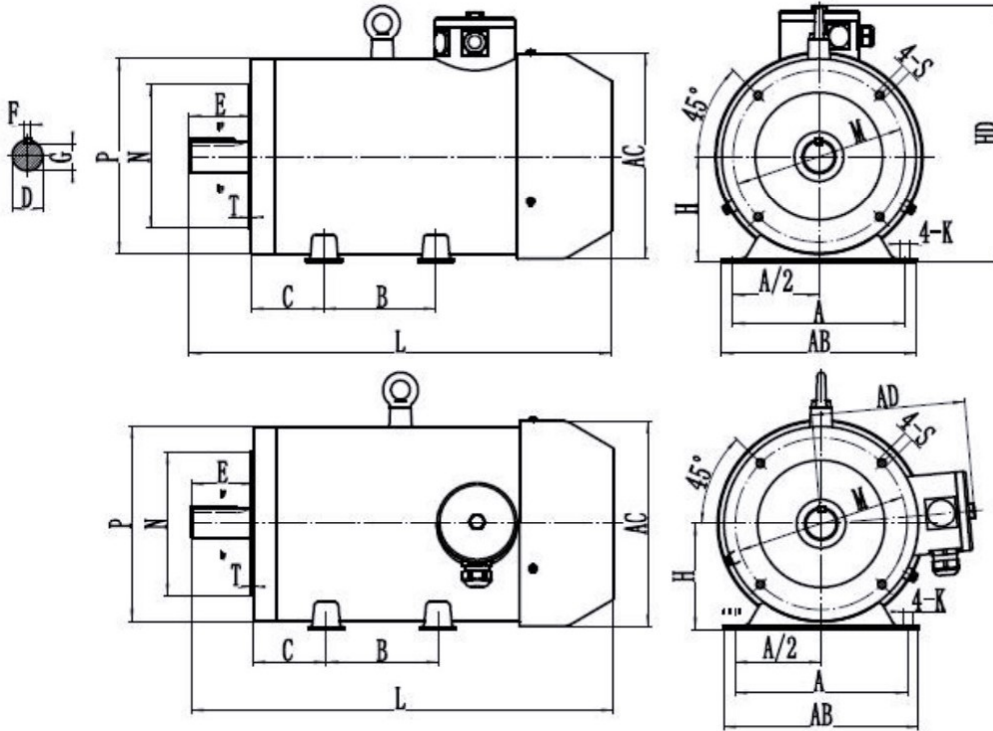

机座号 Frame	极数 Poles	安 装 尺 寸 及 公 差 Mounting Dimension														外 形 尺 寸 Overall Dimension				
		A	B	C	D	E	F	G	H	K	M	N	P	S	T	AB	AC	AD	HD	L
80M1	2,4																			308
80M2	2,4	125	100	50	19	40	6	15.5	80	10	100	80	144	4-M6	3	155	158	135	215	328
	6																			338
90S	2,4,6	140	100	56	24	50	8	20	90	10	115	94	164	4-M8	3	165	178	150	240	354
90L	2,4,6		125																	389
100L/L2	2,4	160	140	63	28	60	8	24	100	12	130	110	186	4-M8	3.5	190	200	160	260	449
100L1/L	4,6																			409
112M	2,6	190	140	70	28	60	8	24	112	12	130	110	206	4-M8	3.5	220	220	180	292	427
	4																			457
132S1/S	2,4,6	216	140	89	38	80	10	33	132	12	165	130	244	4-M10	3.5	245	260	200	332	496
132M1	6		178																	
132S2	2		140																	
132M	4		178																	
132M2	6																			
160M1	2	254	210	108	42	110	12	37	160	15	265	230	298	4-M12	4	300	314	240	400	604
160M	4,6																			
160M2	2																			
160L	2,4,6																			254
180M	2,4	279	241	121	48	110	14	42.5	180	15	300	250	337	4-M12	4	340	355	260	440	709
180L	4,6		279																	734

外形及安装尺寸 Dimensions

mm

B3 (机座带底脚、端盖无凸缘)

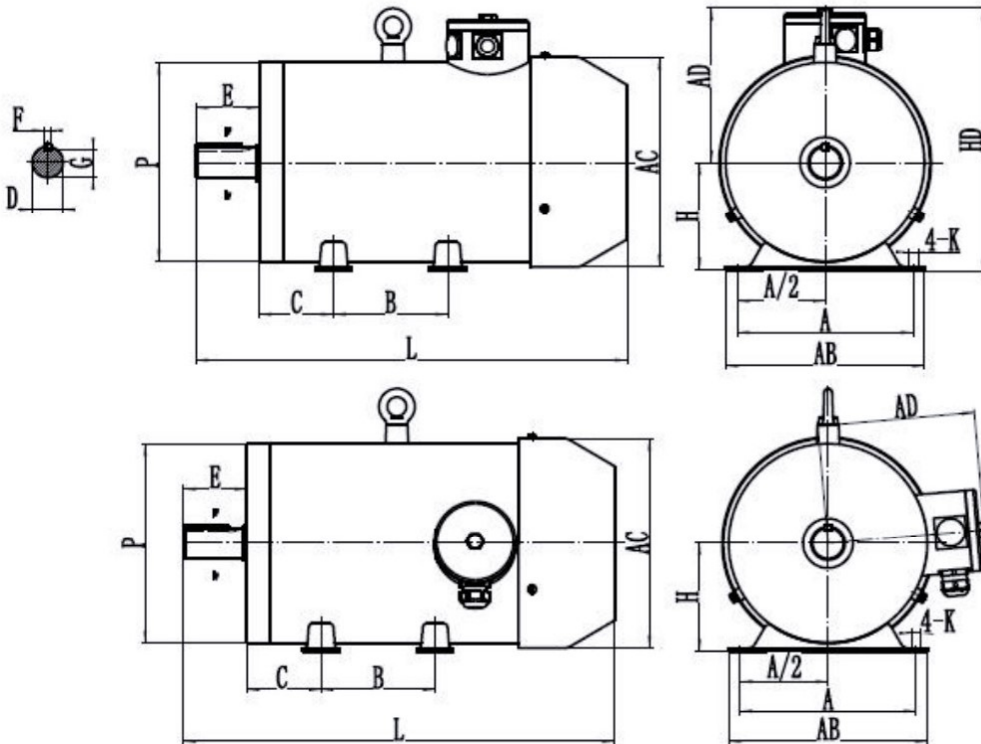

机座号 Frame	极数 Poles	安 装 尺 寸 Mounting Dimension										外 形 尺 寸 Overall Dimension				
		A	B	C	D	E	F	G	P	H	K	AB	AC	AD	HD	L
80M1	2,4,6	125	100	50	19	40	6	155	80	80	10	155	158	135	215	308
80M2	2,4															328
	6															338
90S	2,4,6	140	100	56	24	50	8	20	164	90	10	165	178	150	240	354
90L	2,4,6		125													389
100L/L2	2,4	160	140	63	28	60	8	24	186	100	12	190	200	150	250	385
100L1/LL	4,6															345
112M	2,6	190	140	70	28	60	8	24	206	112	12	220	220	180	292	427
	4															457
132S1/S	2,4,6	216	140	89	38	80	10	33	244	132	12	245	260	200	332	496
132M1	6		178													
132S2	2		140													
132M	4,		178													541
132M2	6															
160M1	2	254	210	108	42	110	12	37	298	160	15	300	314	240	400	604
160M	4,6															644
160M2	2															
160L	2,4,6															254
180M	2,4	279	241	121	48	110	14	42.5	337	180	15	340	355	260	440	709
180L	4,6		279													734

★注：电机外形图仅供参考